

Storage compartments/covers

Removing and installing centre console

- Make improvised tool for dismantling vents.
- → Bend a $\varnothing 3$ mm wire as shown in the illustration.
 - Dimension x = 6 mm
- Remove telephone/mobile phone receiver holder => Page [68-28](#).
- Move front seats to furthest rearward position.
- Remove floor covering on left and right => Page [70-32](#).
- Turn accelerator pedal stop 1/4 turn (90°) anti-clockwise.

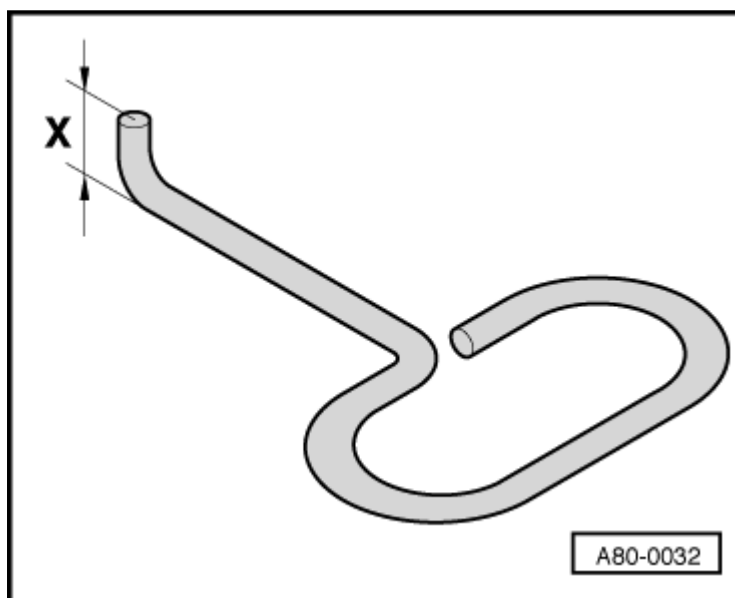

- → Remove bolts -1- and -2-.
- Detach left trim from centre console - 3-.
 - To detach, push trim forwards and disengage at rear.

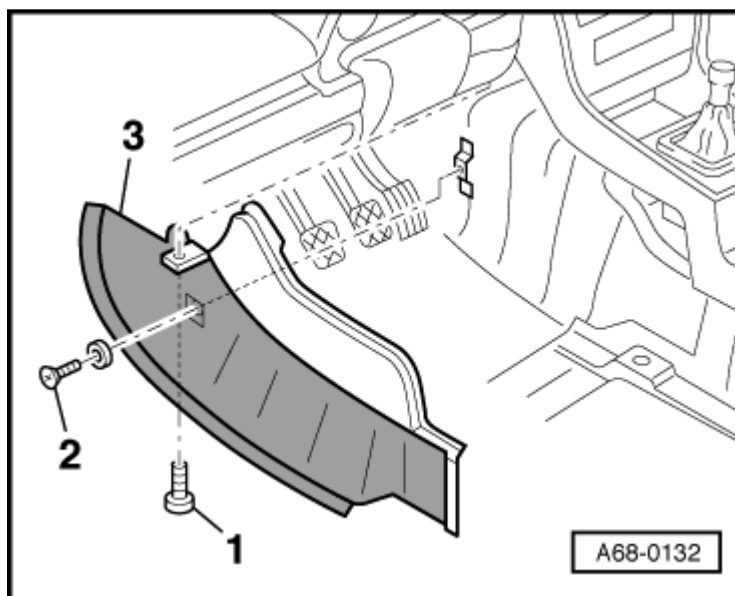

- → Remove bolts -2- and -3-.
 - Front bolts -2- become accessible after folding back floor covering.
- Detach right trim from centre console -1-.
 - To detach, push trim forwards and disengage at rear.

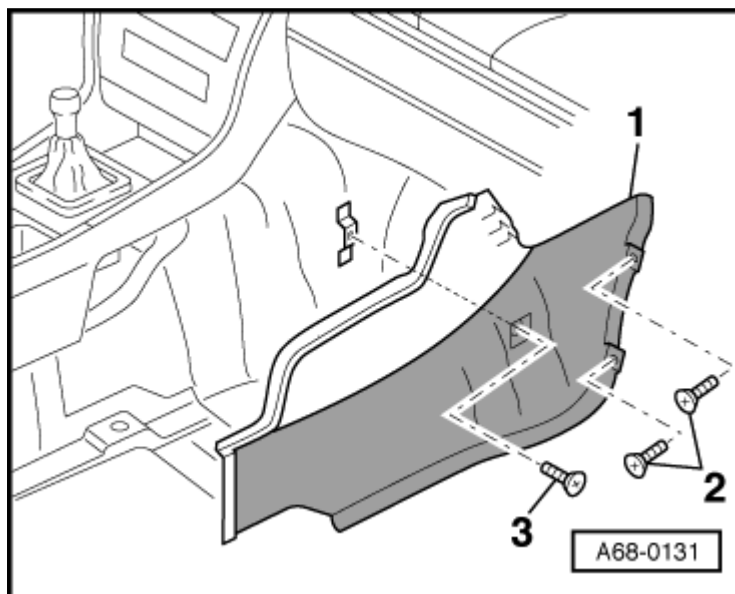

- Pull up handbrake lever as far as it will go.
- → Lever out locking pin -2- in direction of arrow -A-.
- Detach handle of handbrake lever -1- in direction of arrow -B-.

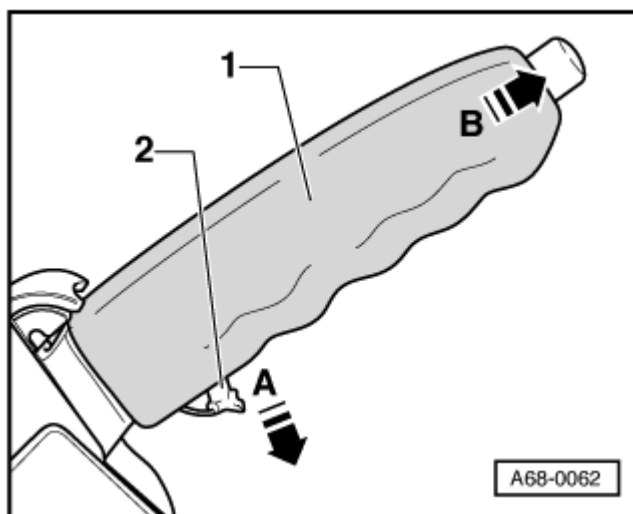

- → Lever off trim -1- and loosen clamping bolt -arrow- approx. 2 turns.
- Detach cover panel from handbrake trim -2- frontward.

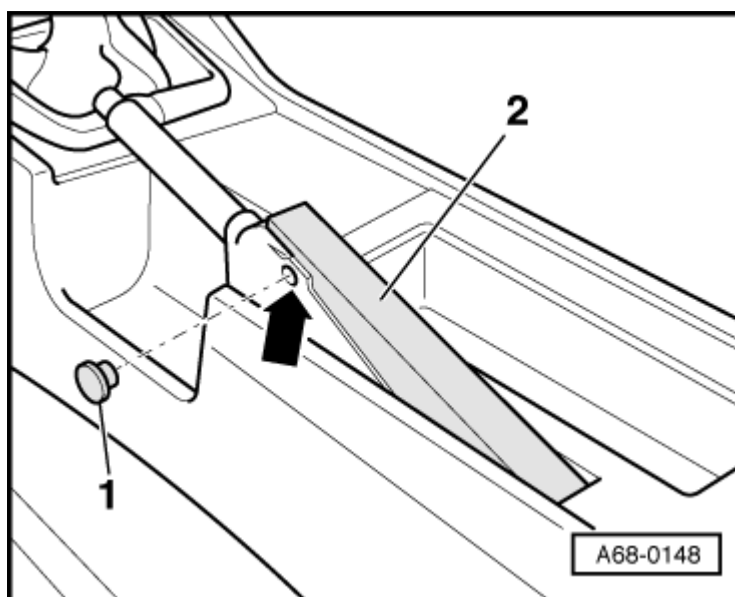

- → Detach handbrake trim.
- Retaining lug at rear narrow side of trim.

Vehicles with manual gearbox:

- Screw off gear lever knob and engage 4th gear.

Vehicles with centre armrest:

- Remove centre armrest => Page [68-26](#).

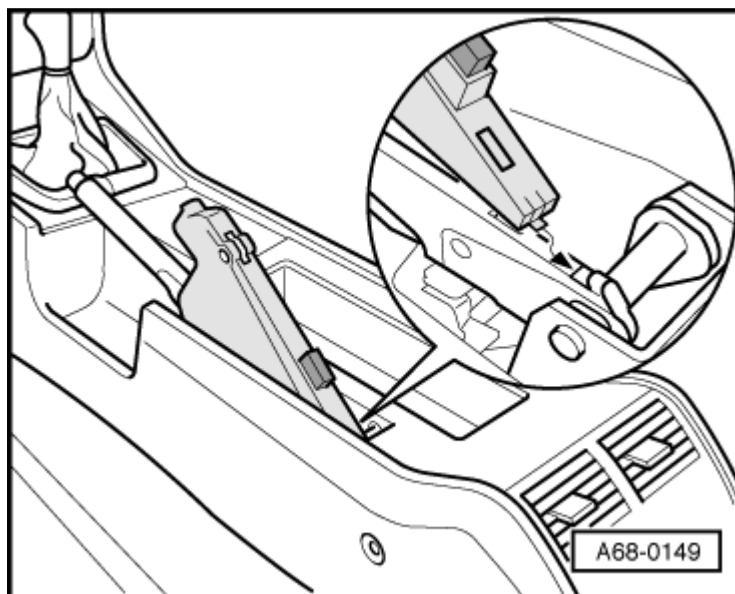
All models:

- → Unclip trim -2-.
- Remove bolts -3-.
- Detach rear vent -1-.

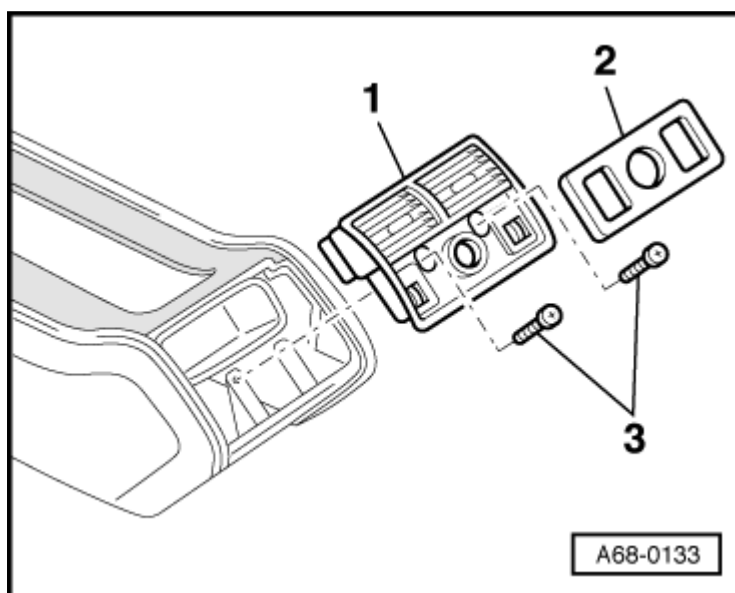

- → Insert auxiliary tool -C- in holes of dash panel vents -D-.
- Pull on dash panel vents evenly to remove from centre section of dash panel.

Note:

Do not hook auxiliary tools -C- onto the slats of the dash panel vents, as slats could snap off.

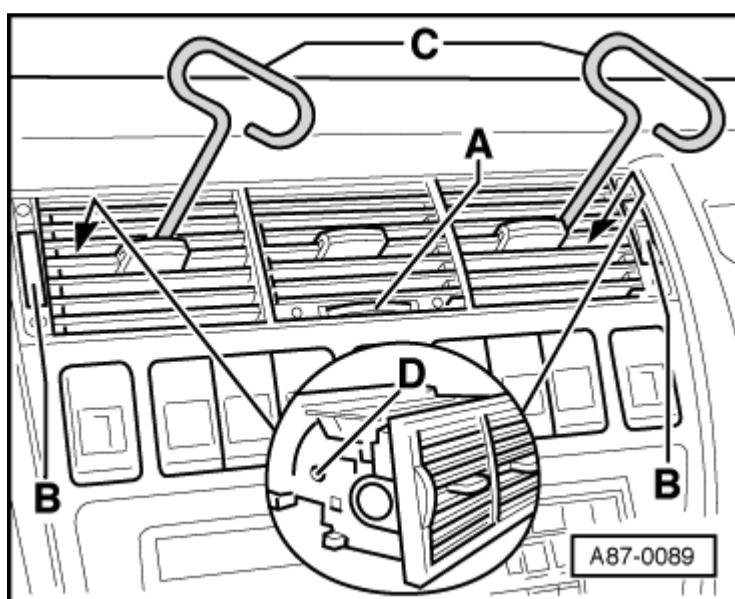

- → Screw out 5 bolts -arrows-.

- Detach centre section of dash panel - 1- and detach connectors.

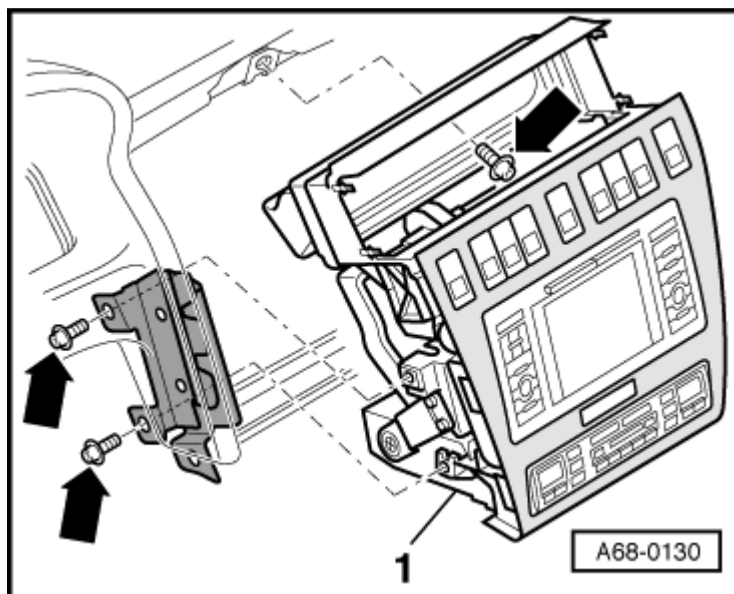

- → Screw out bolts -4- on left and right.
- Press ashtray -1- forwards.
- Remove bolts -3-.
- Where applicable, use sharp knife to cut through bonded joint between centre console -2- and dash panel.
- Lift rear of centre console and guide it out frontward over handbrake lever.

