

Removing and installing housing for electric sun blind

Special tools and workshop equipment required

t Torque wrench -V.A.G 1783-

Removing

- Remove the door trim → [Chapter](#).
- Remove the insulation → [Chapter](#).

Sun blind removal involves setting it to service mode. To do so, use the switch in the roof module to unwind the sun blind in the rear door.



Note

Moving electric sun blind with defective drive unit → [Chapter](#).

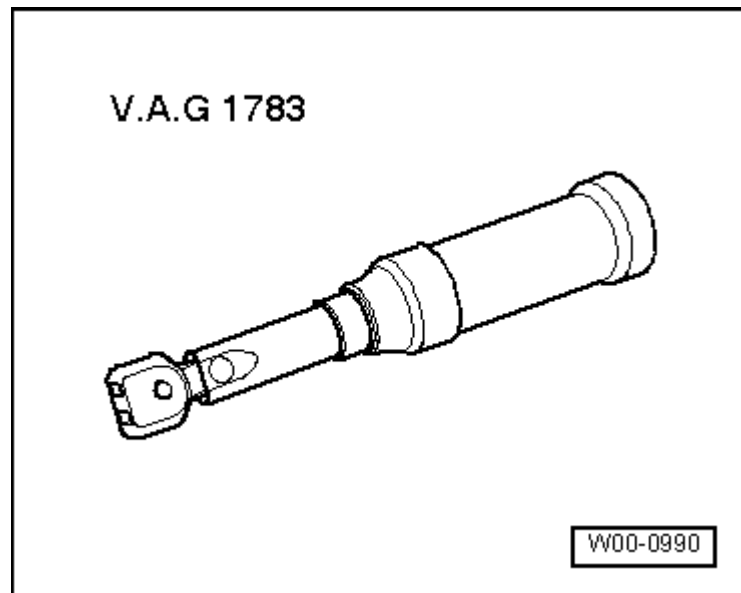

- Retract the sun blind in the rear door again by pressing the switch in the roof module for at least 5 seconds.
- Unplug the connector -4- to the sun blind control unit.
- Plug in the connector -4- to the sun blind control unit. This activates service mode.

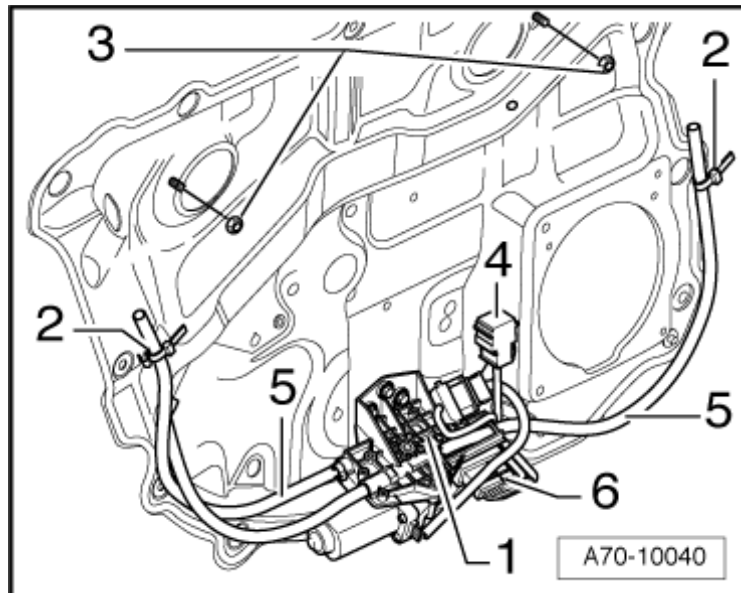

- Actuate the switch in the roof module. The sun blind extends by approx. 150 mm.
- Unscrew the window regulator motor → [Rep. gr.58](#).
- Push down the door window.
- Use a small flat screwdriver to unfasten the clips -2- on the upper side between the roller -4- and the clip -2-.
- Pull the shafts -5- out of the mounts -3-. In doing so, hold the roller blind to stop it retracting.

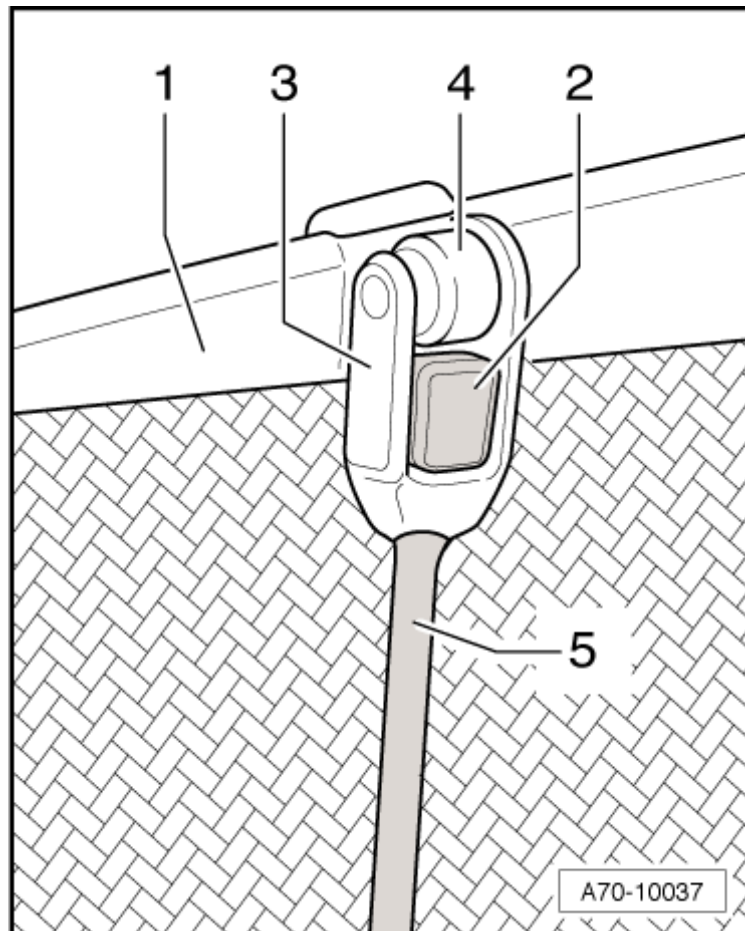

- A second mechanic is required for implementation of the next two steps.
- Hold the cover -1- open and allow the sun blind -2- to almost fully retract.

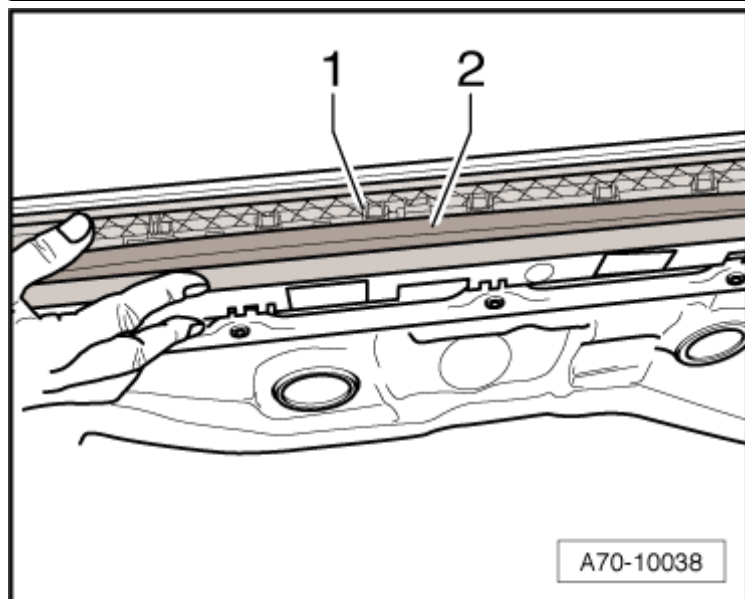

- Retract the shafts by pressing the switch in the roof module for at least 5 seconds.
- Unplug the connector -4- to the sun blind control unit.

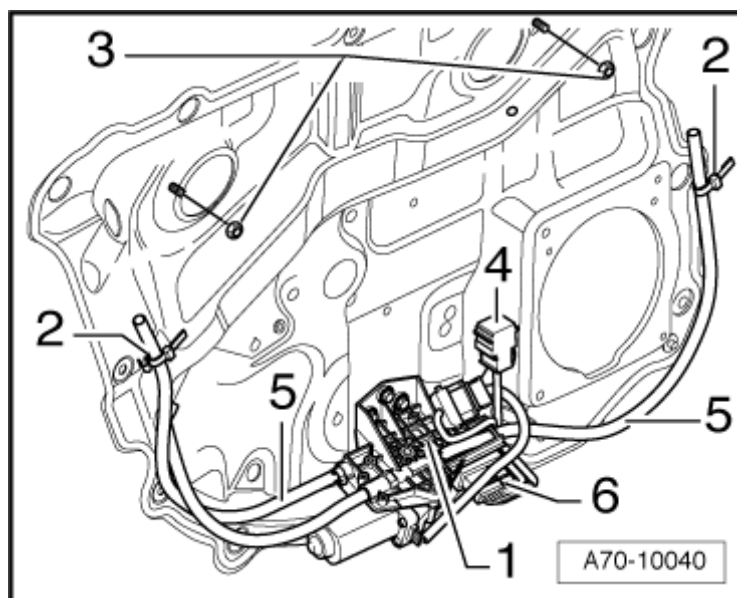

- Unscrew the bolts -2- (5x).
- Carefully lift out the sun blind housing -1-.

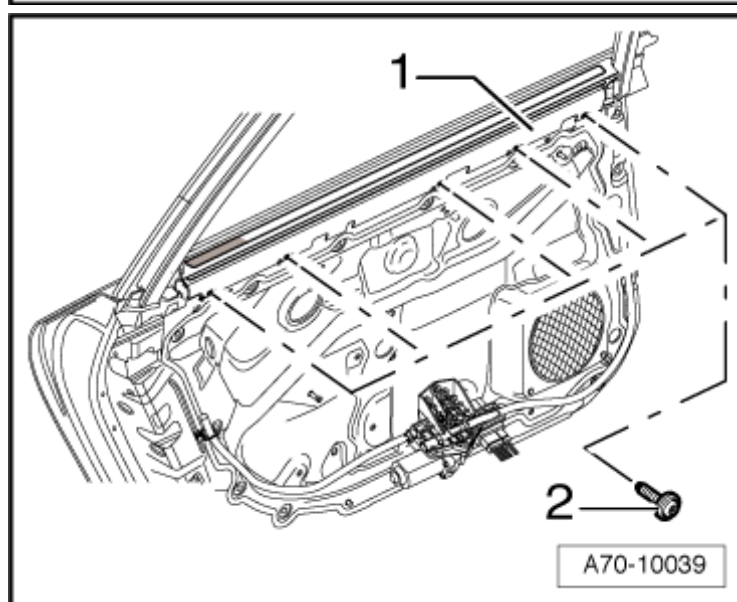

Installing

- Hold the cover -1- open.

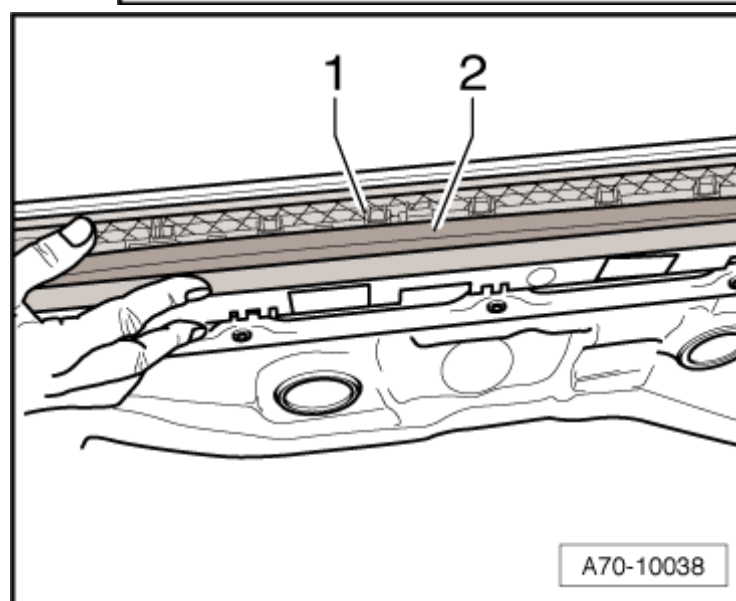

- Pull the sun blind -2- slightly out of the housing.

- Slide the sun blind housing -1- onto the door frame, inserting the shafts in the sun blind housing -1- such that the ends of the shafts are visible.



Note

The sun blind must not retract into the housing.

- Use the bolts -2- (5x) to screw on the sun blind housing. 3 Nm.

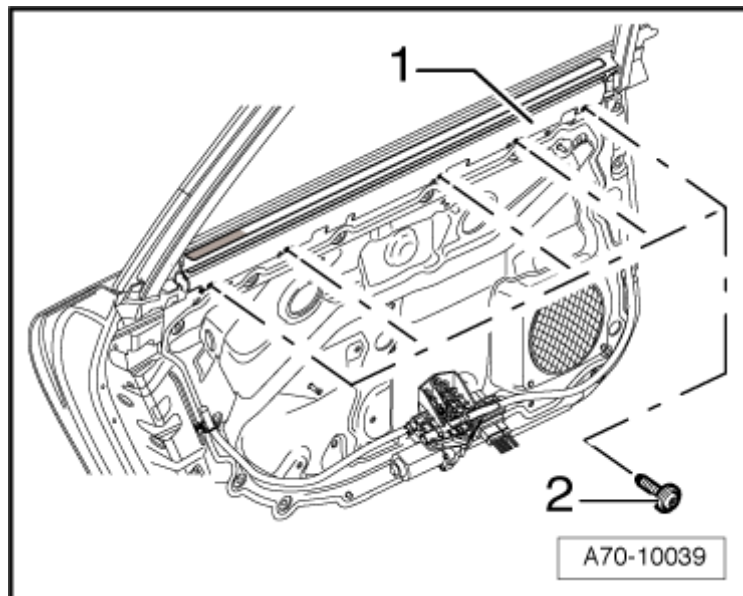

- Plug in the connector -4- to the sun blind control unit.
- Plug in the connector to the window regulator motor.

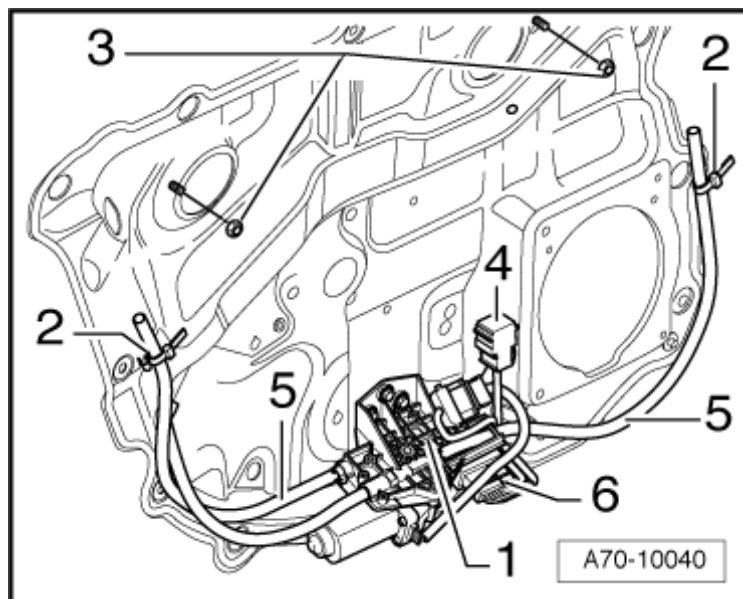

- A second mechanic is required for implementation of the next two steps.
- Open the cover of the sun blind housing again and pull out the blind slightly.
- Use the switch in the roof module to extend the shafts (approx. 150 mm).
- Pull out the sun blind until it can be engaged at the shafts.
- Fasten the clips -2- (2x).
- Use the switch in the roof module to retract the sun blind.
- Install the window regulator motor
→ [Rep. gr.58](#).
- Close the window.

The electric sun blind must be re-adapted; proceed as follows.

- Fully extend the sun blind by way of the switch in the roof module and keep actuating the switch for at least a further 6 seconds. This starts an automatic initialisation process.
- Install the door trim → [Chapter](#)

