

**Audi > D2 > 1997-2003**

**5 Spd. Automatic Transmission 01L All Wheel Drive**

**37 - Transmission, removing and installing**

**Transmission supports, (right and left), removing and installing**

**CAUTION!**

**If both transmission supports are removed, the transmission must be supported using the VAG1383A lift. If only one support is removed, the other provides sufficient support.**

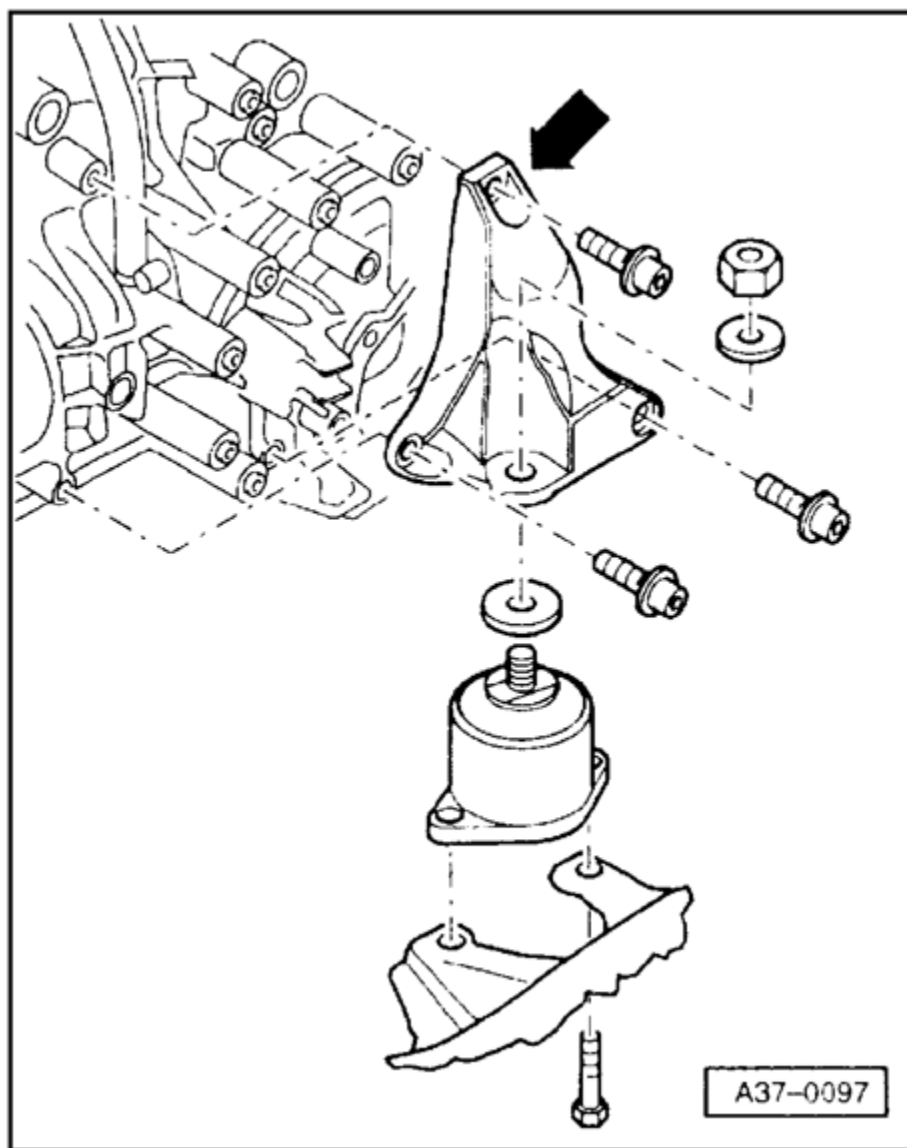

- Remove right transmission support complete with transmission mount.

**Note:**

- ♦ *The transmission support is not detached from the transmission mount.*

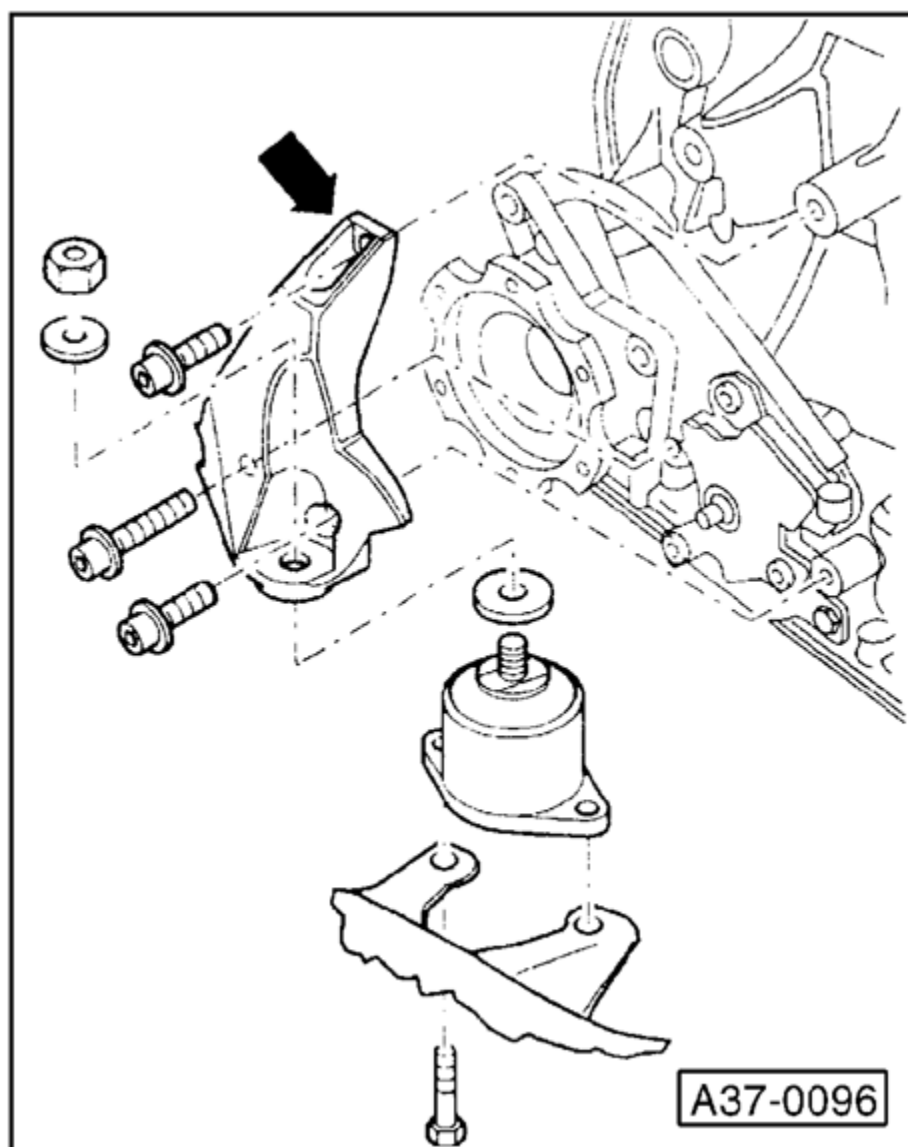

- Remove left transmission support complete with transmission mount.

**Note:**

- ♦ *The transmission support is not separated from the transmission mount.*

**Tightening torques**

Component	Tightening torque
Transmission support to transmission M10	42 Nm
Transmission support to transmission mount M10	42 Nm

Transmission mount to subframe M10	40 Nm
------------------------------------	-------

*Copyright © 2006 Audi of America, Inc. and Bentley Publishers. All rights reserved. Last processed:*