

## Fuel delivery unit - 6-cyl. and 8-cyl. engine

### Testing fuel pump delivery rate

- ☐ V.A.G 1348/3A with V.A.G 1348/3-2
- ☐ V.A.G 1318/10
- ☐ V.A.G 1318/14
- ☐ Measuring container (fuel-resistant)

#### Requirements for test:

- Battery voltage not less than 12.7 V
- Fuel filter OK
- Ignition switched off

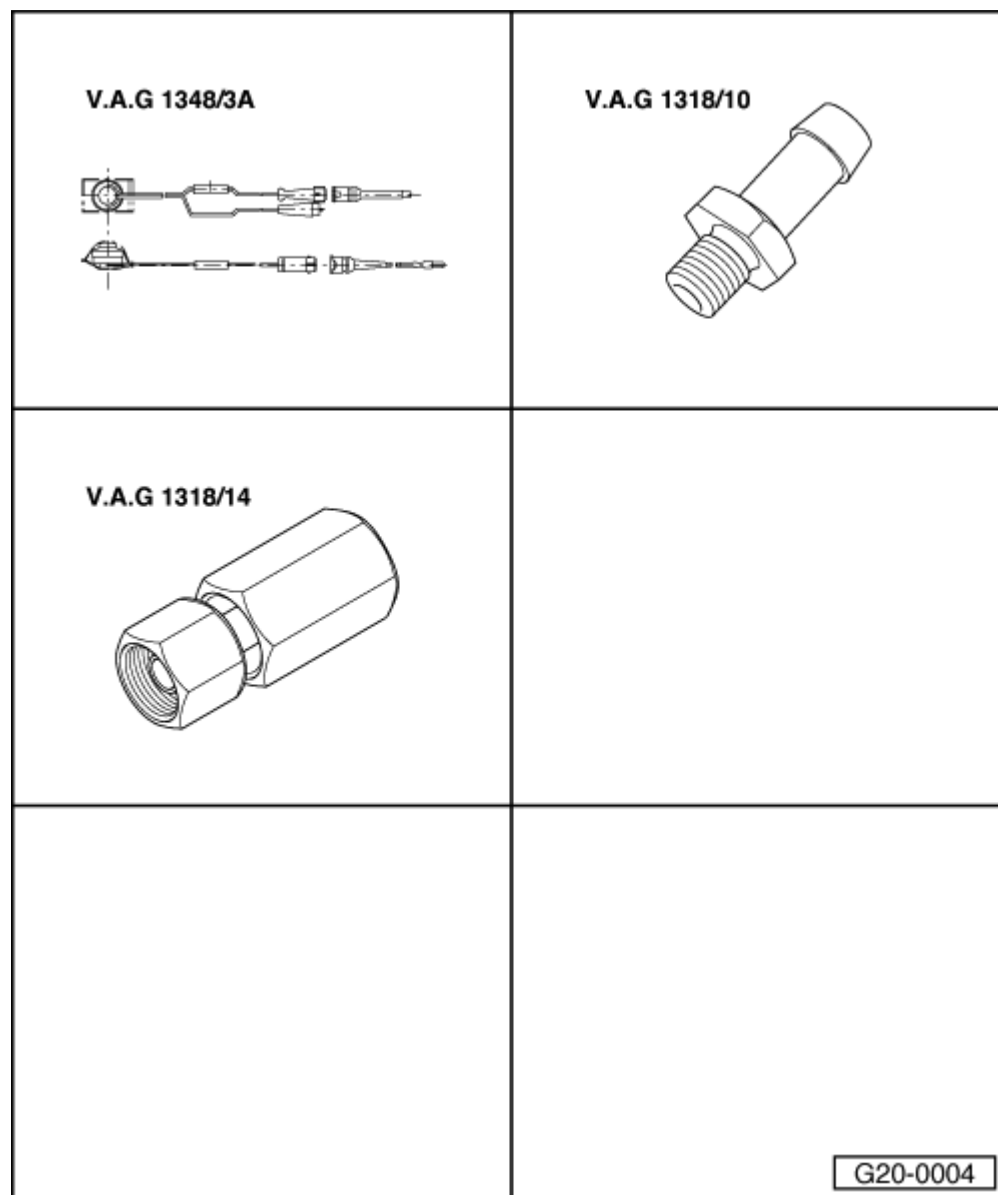

#### Test sequence

- Detach floor covering at front of passenger's footwell.
- → Unscrew knurled screw -1-.
- Pull trim -2- out of clip -3- towards the rear.
- Detach trim.

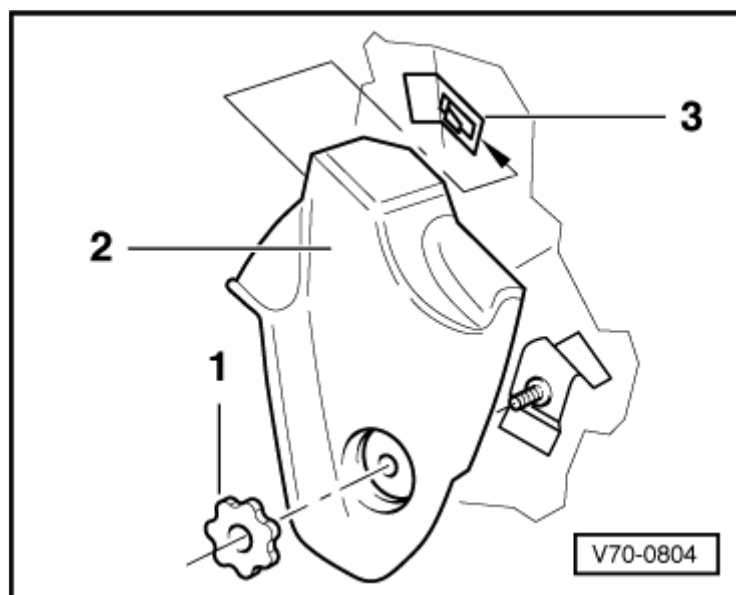

- → Pull fuse No. S1 out of fuse carrier ST4 in fuse box.

ST4 - blue fuse carrier

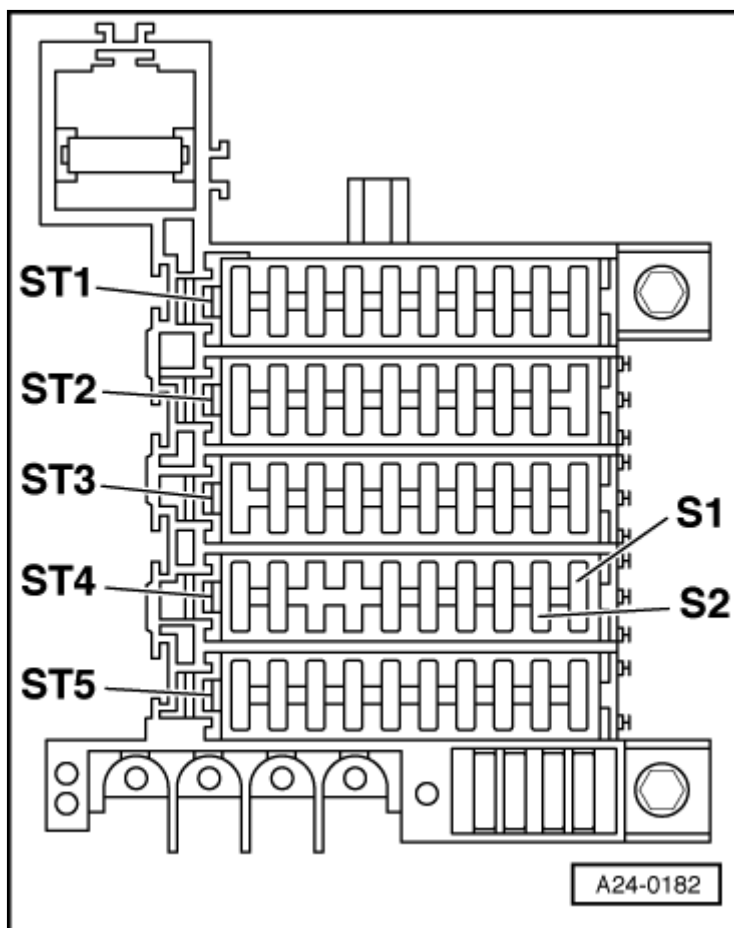

- → Connect remote control V.A.G 1348/3A with adapter cable V.A.G 1348/3-2 to lower terminal of socket for fuse No. S1 in fuse carrier ST4 - arrow 1-.
- Connect clamp to positive battery supply (e.g. socket of 60 A fuse - arrow 2- at top of fuse box).
- Remove engine cover panel.

**Warning**

**Fuel system is under pressure. Before opening the system place a cloth around the connection. Then release pressure by carefully loosening the connection.**

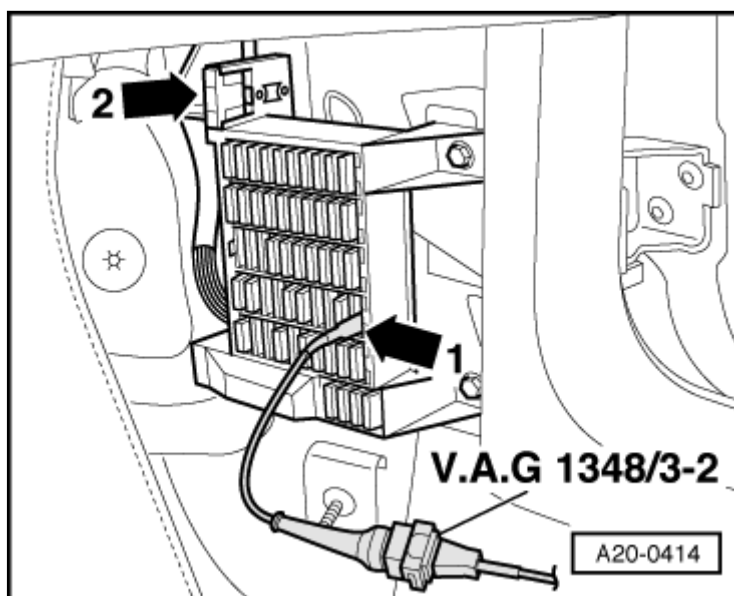

**Vehicles with 6-cylinder engine and screw connection on return hose:**

- → Unscrew fuel return hose at fuel pressure regulator.
- Attach adapter V.A.G 1318/14 and V.A.G 1318/10 at fuel pressure regulator.
- Connect extension hose -arrow- and

hold end of hose in measuring container.

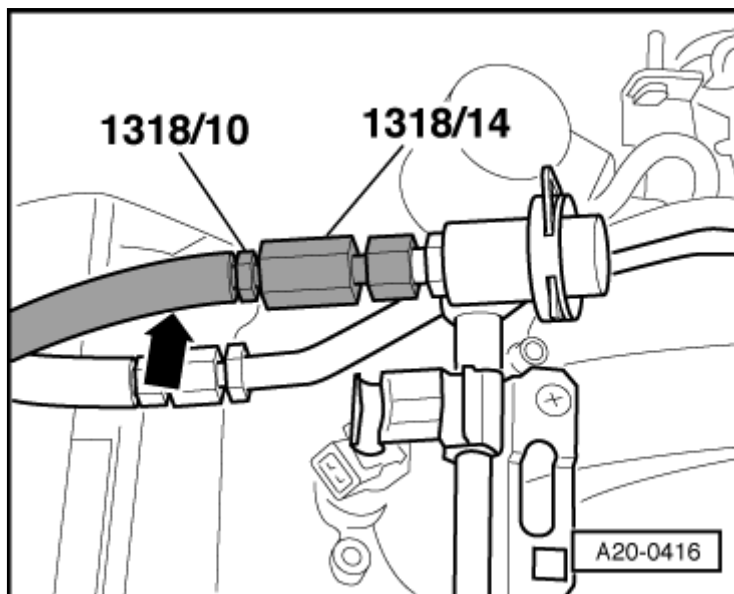

#### Vehicles with 8-cylinder engine and screw connection on return hose:

- → Unscrew fuel return hose at fuel pressure regulator.
- Screw on extension hose (Part No. 8A0 201 351 A) and hold end of hose in measuring container.

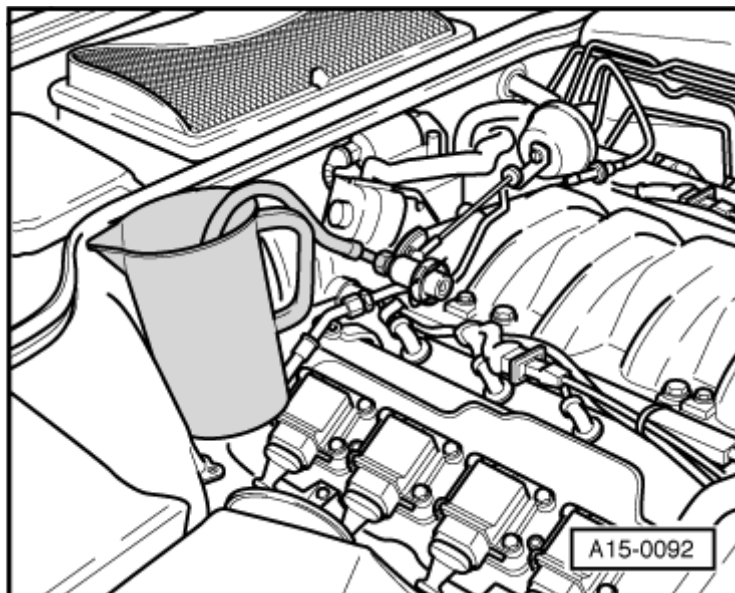

#### Vehicles with push-fit connection on return hose:

- → Pull off fuel return hose at connection on fuel distribution pipe.
- Connect extension hose -arrow- to fuel distribution pipe and hold end of hose in measuring container.

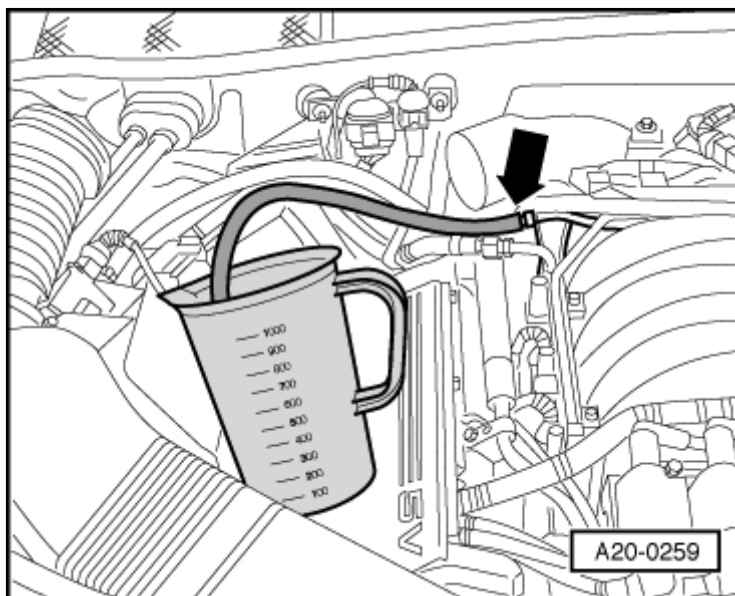

All models

- Operate remote control for 15 seconds (keep button pressed).
- → Compare the quantity of fuel delivered with specification.

\*) Minimum delivery cm<sup>3</sup>/15 seconds

\*\*) Voltage at fuel pump with engine stopped and pump running (approx. 2 volts less than battery voltage).

#### **Vehicles with screw connection on return hose:**

- Connect return hose and tighten to 23 Nm.

#### **Vehicles with push-fit connection on return hose:**

- Attach return hose and secure with new hose clamp.

#### **Note:**

*Secure all hose connections with the correct hose clips (same as original equipment)*

=> Parts catalogue

