

Audi > A8/A8L > 2004-2008

Body Interior

70 - Removal and Installation

.

Front Door Trim

- ⇒ [Front Door Trim](#)
- ⇒ [Trim Molding](#)
- ⇒ [Front Door Trim Molding](#)
- ⇒ [Insulation](#)
- ⇒ [Front Door Armrest](#)
- ⇒ [Window Regulator Switch Strip](#)
- ⇒ [Mirror Adjustment Switch](#)
- ⇒ [Interior Door Release Mechanism with Central Locking Switch](#)
- ⇒ [Door Warning Lamps and Footwell Lighting](#)
- ⇒ [Interior Monitoring Switch Strip](#)
- ⇒ [Hinged Pocket with Mount](#)
- ⇒ [Hinged Pocket](#)
- ⇒ [Tank Door/Rear Lid Release Switch](#)

.

Front Door Trim

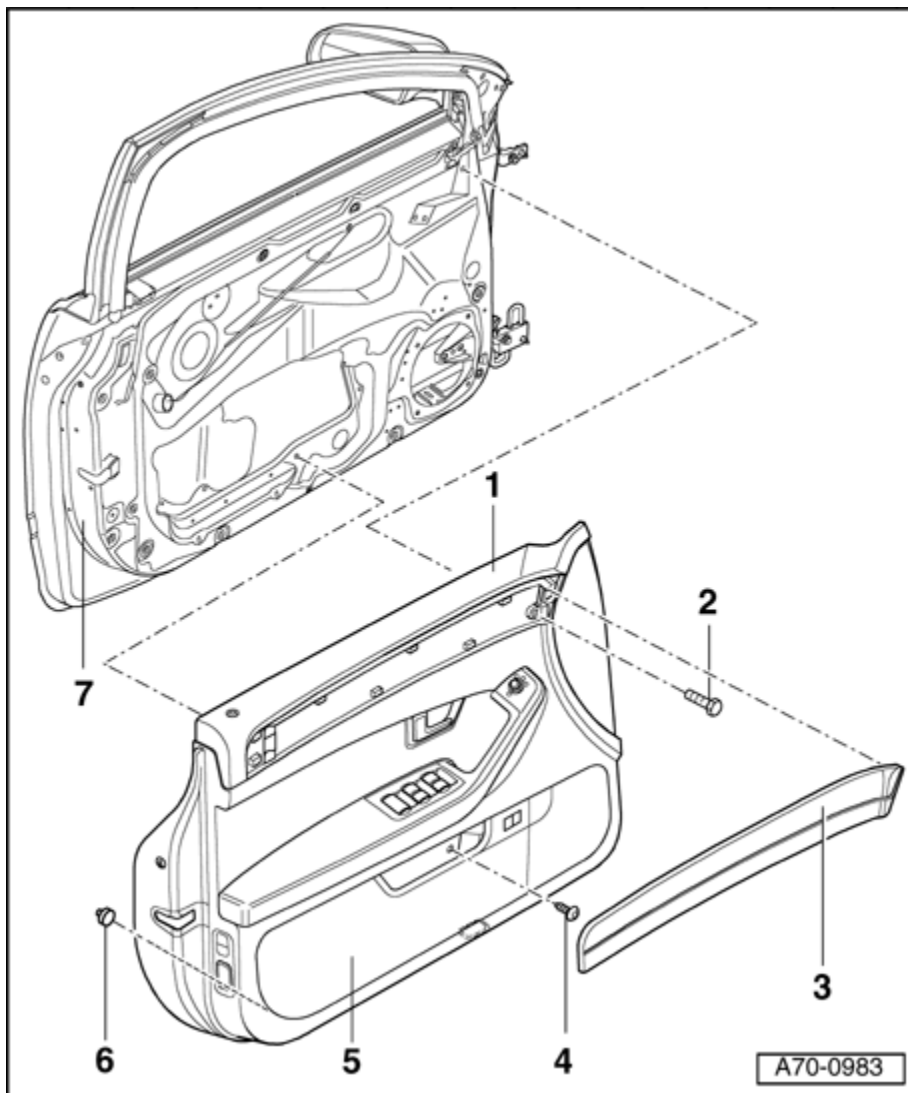

1 - Door trim

◆ Removing

- Remove decorative panel - **3** - ⇒ [Trim Molding](#) .
- Remove screw - **2** - .
- Close the hinged pocket - **5** - .
- Remove screw - **4** - .
- Unclip door trim - **1** - starting from below at clips - **6** - (Qty. 8).
- Disengage release for interior door mechanism ⇒ [Disengaging release cable for interior door mechanism](#)
- Disconnect harness connector on window regulator control module ⇒ [Connector on](#)

[window regulator control module](#) .

♦ Installing

- Make sure that all clips - **6** - on rear side of door trim are clipped in. Replace damaged clips ⇒ [Door trim securing clip](#) .
- Install door trim - **1** - in reverse order of removal.

2 - Screw

- ♦ Tightening torque: 4 Nm.

3 - Trim panel

4 - Screw

- ♦ Tightening torque: 4 Nm.

5 - Hinged pocket with mount

6 - Clips (Qty. 8)

7 - Door shell

.

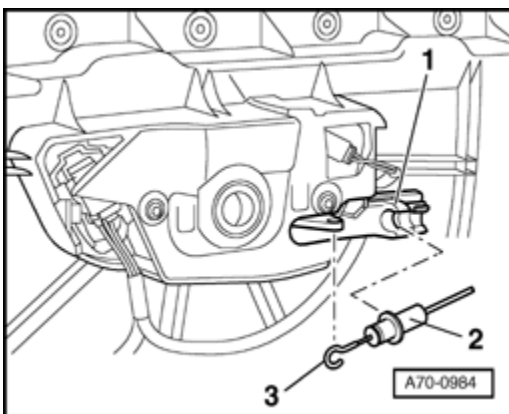

Disengaging release cable for interior door mechanism

- Pull release cable - **2** - from guide - **1** - .

-

.

Disengage hook - **3** - .

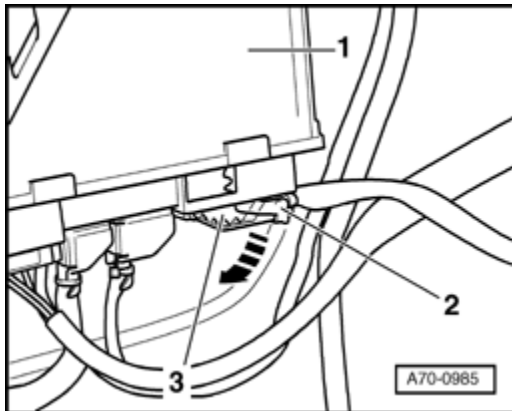

Connector on window regulator control module

- Open securing clip - **2** - and disconnect connector - **3** - in direction of - **arrow** - from control module - **1** - .

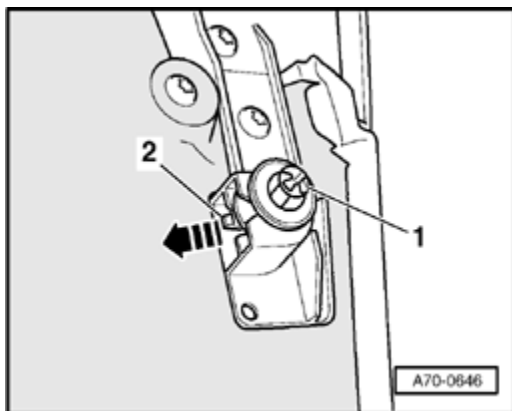

Door trim securing clip

- Press catch - **2** - and remove clip - **1** - in direction of - **arrow** - .

Trim Molding

Removing

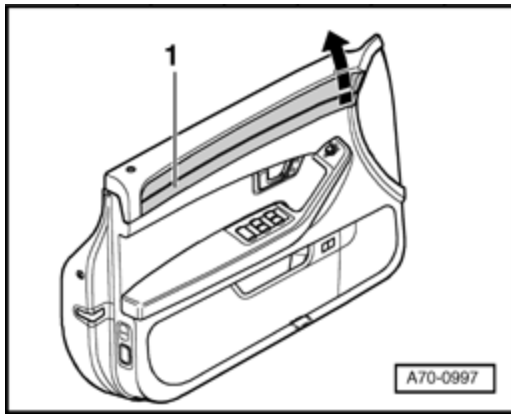

- Carefully pry out decorative panel - **1** - in direction of arrow.
- Remove decorative panel - **1** - toward front.

Installing

- Install decorative panel - **1** - in reverse order of removal.

.

Front Door Trim Molding

Special tools, testers and auxiliary items required

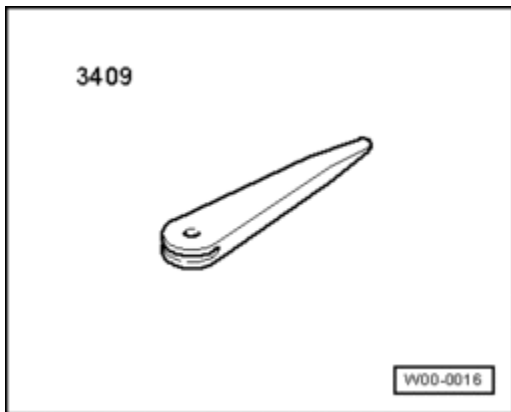

- ♦ Trim removal wedge 3409

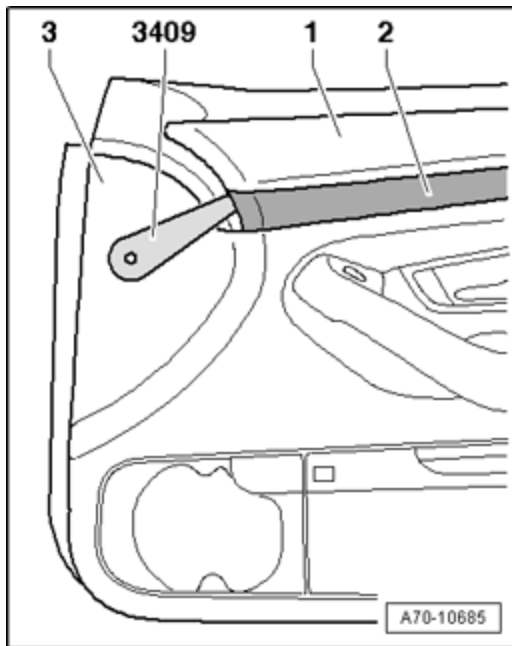

Wood Trim, Removing

- Unclip the wood trim - **1** - from the door trim from front to back by prying it out using the trim removal wedge 3409 .
- Position the trim removal wedge 3409 between the door trim - **3** - and the trim molding - **2** - as shown in the illustration.

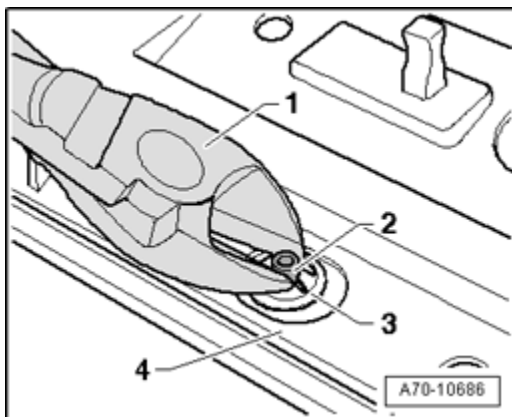

Trim Molding Retaining Lug, Removing

- Lay the wood trim - **4** - on a soft surface.

CAUTION!

Do not scratch or damage the visible side of the wood trim.

- Cut off the retaining lug - **2** - on the back side of the trim molding directly above the ring clips - **3** - .

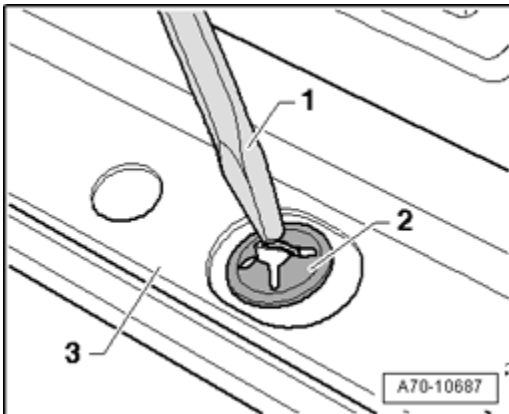

Ring Clips, Removing

- Pry the ring clips - **2** - off the wood trim - **3** - .

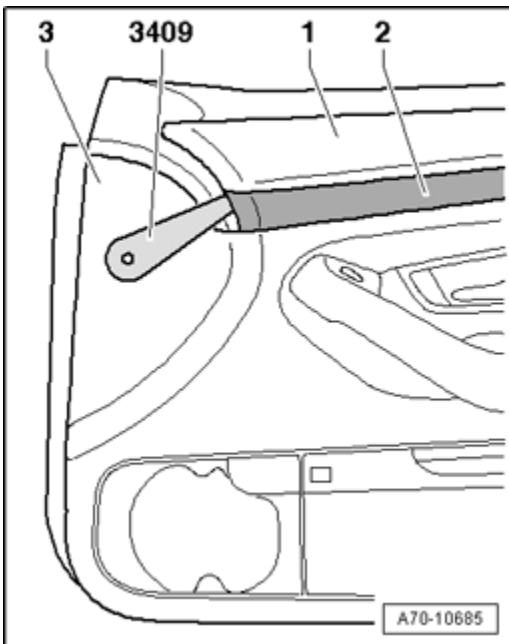

Trim Molding, Removing

- Carefully pull the trim molding - **2** - off the wood trim carrier - **1** - .

The trim molding is secured with double-sided adhesive tape.

- Remove the old double-sided adhesive tape from the wood trim carrier - **1** - .

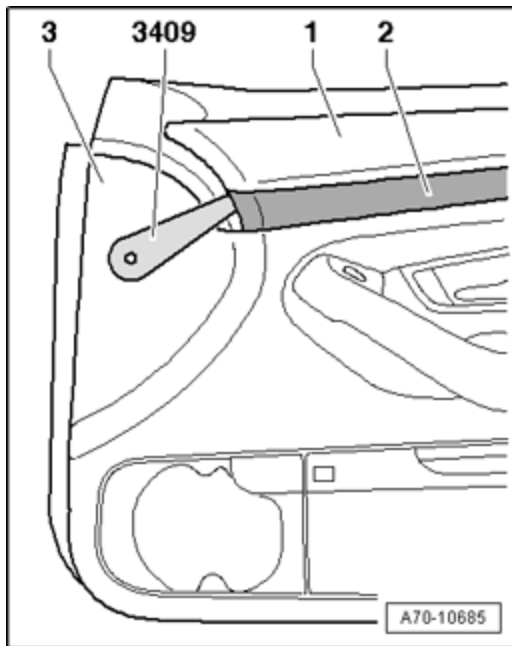

New Trim Molding, Inserting

- Insert the trim molding in the trim carrier.

CAUTION!

Use new double-sided adhesive tape.

- Tape new double-sided adhesive tape to the wood trim carrier - 1 - .

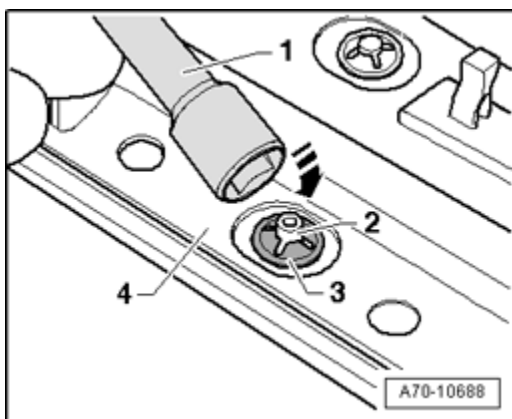

Trim Molding, Securing

Position the ring clips - 3 - on the retaining lug - 2 - .

Press the ring clips - 3 - onto the retaining lug - 2 - .

4 - Wood trim with trim carrier

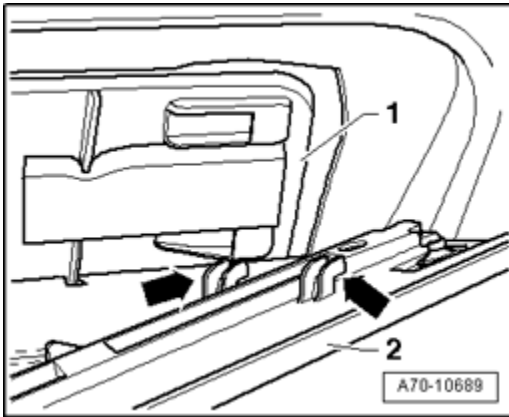

Wood Trim, Inserting in Door Trim

- Insert the wood trim - **2** - with the retaining hooks - **arrows** - into the door trim - **1** - .
- Engage the wood trim in the clips beginning at the rear and working forward and engage them by pressing.

▪

Insulation

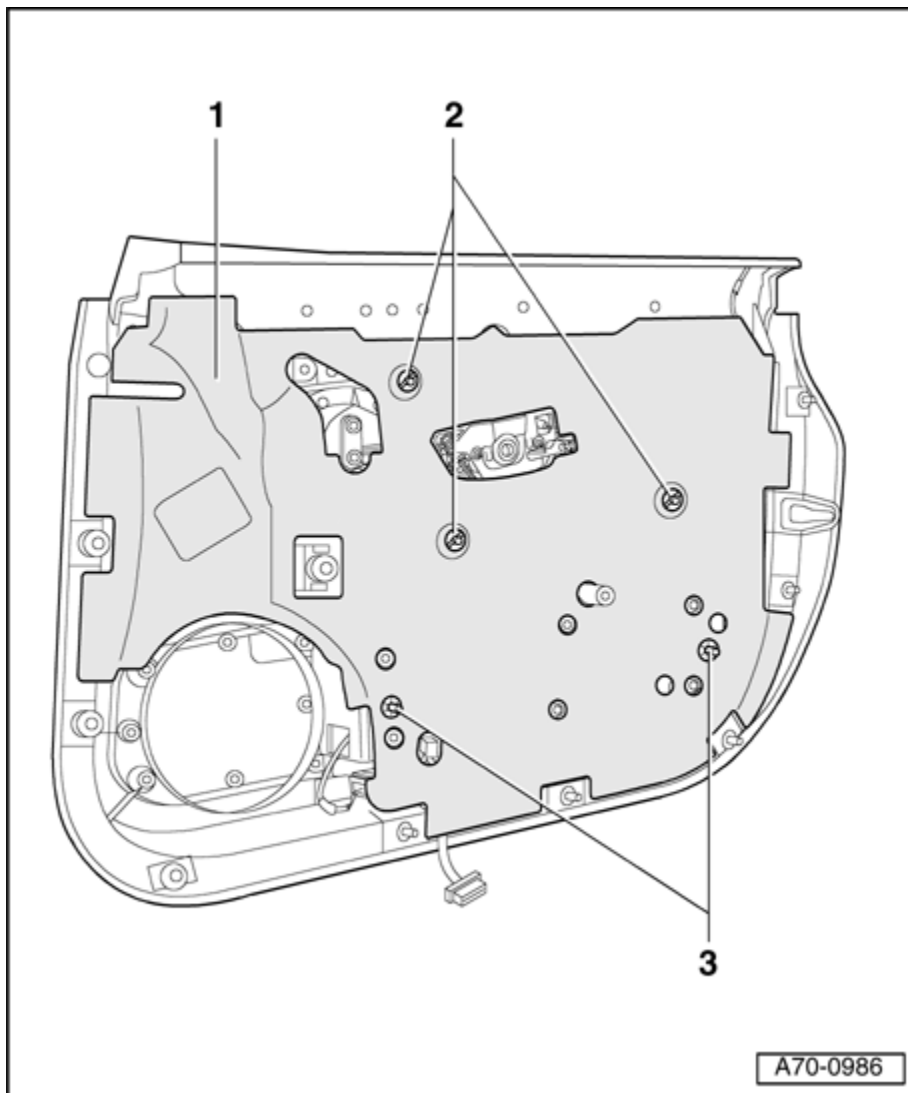

1 - Insulation

◆ Removing

- Remove door trim ⇒ [Front Door Trim](#) and ⇒ [Front Door Trim](#) .
- Unscrew brackets - **2** - (Qty. 3).
- Using a screwdriver, pry off circlips - **3** - (Qty. 2).
- Remove insulation - **1** - .

◆ Installing

- Install insulation - **1** - in reverse order of removal.

2 - Brackets (Qty. 3)

3 - Circlips (Qty. 2)

Front Door Armrest

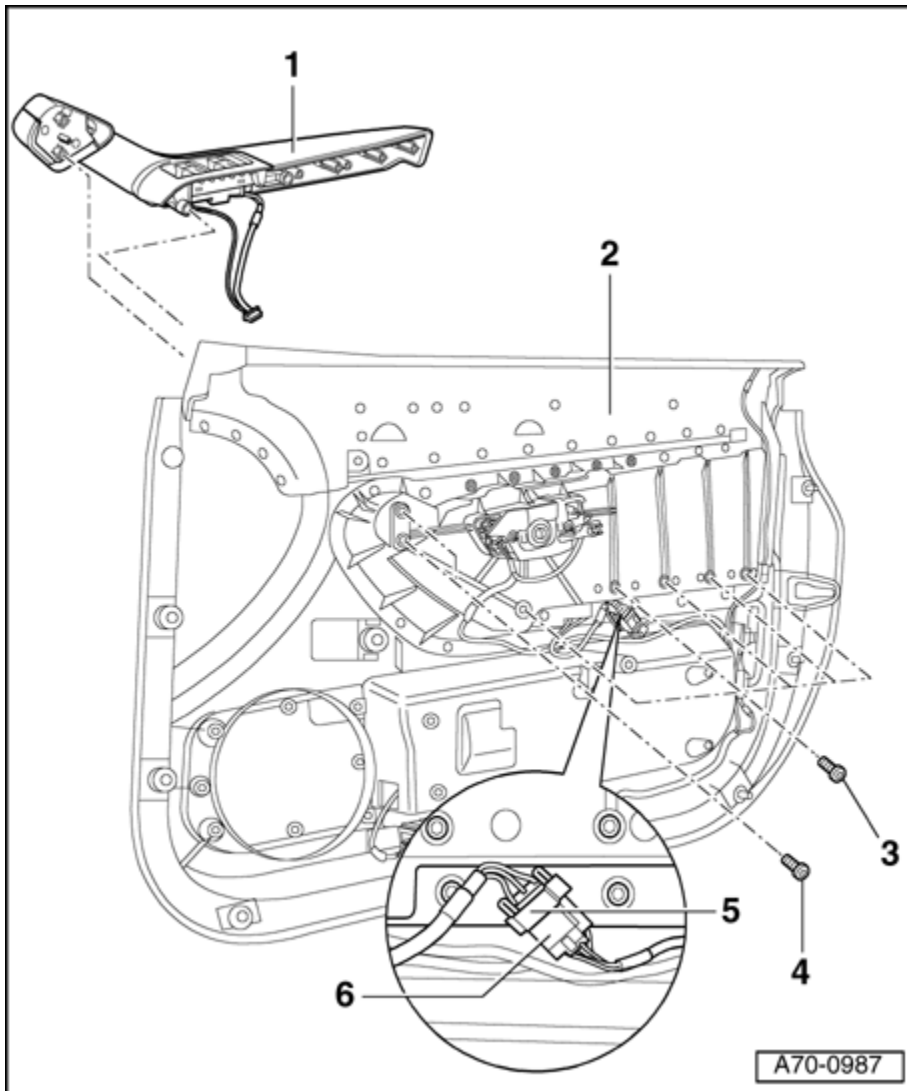

1 - Armrest

♦ Removing

- Remove door trim ⇒ [Front Door Trim](#) and ⇒ [Front Door Trim](#) .
- Remove insulation ⇒ [Insulation](#) and ⇒ [Front Door Trim](#) .
- Remove bolts - 4 - (Qty. 2).

- Remove bolts - **3** - (Qty. 9).
- Unclip connector guide - **5** - from door trim - **2** - .
- Disconnect connector - **6** - .
- Remove the connector guide - **5** - from the connector - **6** - .
- Remove armrest - **1** - .

♦ Installing

- Install armrest - **1** - in reverse order of removal.

2 - Door trim

3 - Screws (Qty. 9)

4 - Screws, (Qty. 2)

5 - Connector guide

6 - Harness connector for window regulator switch strip and mirror adjustment switch

.

Window Regulator Switch Strip

Removing

- Remove door trim ⇒ [Front Door Trim](#) .
- Remove insulation ⇒ [Insulation](#) and ⇒ [Front Door Trim](#) .
- Remove armrest ⇒ [Front Door Armrest](#) .

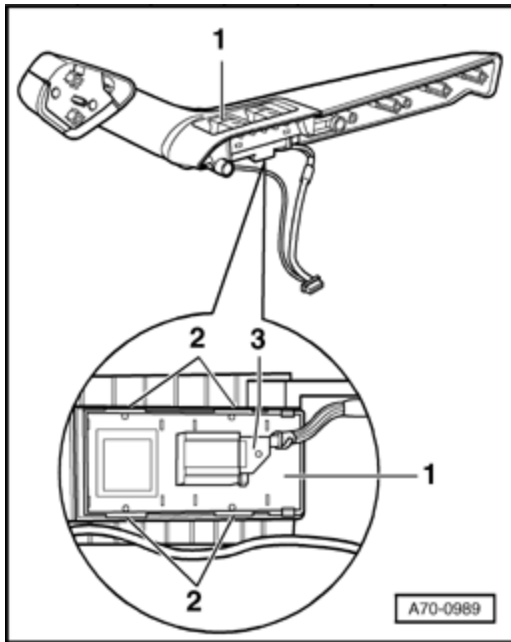

- Using a screwdriver, pry out window regulator switch strip - **1** - at positions - **2** - (Qty. 4).
- Remove connector - **3** - .

Installing

- Install window regulator switch strip - **1** - in reverse order of removal.

.

Mirror Adjustment Switch

Removing

- Remove door trim ⇒ [Front Door Trim](#) .
- Remove insulation ⇒ [Insulation](#) and ⇒ [Front Door Trim](#) .
- Remove armrest ⇒ [Front Door Armrest](#) .
- Disassemble armrest ⇒ [Front Door Armrest](#) .

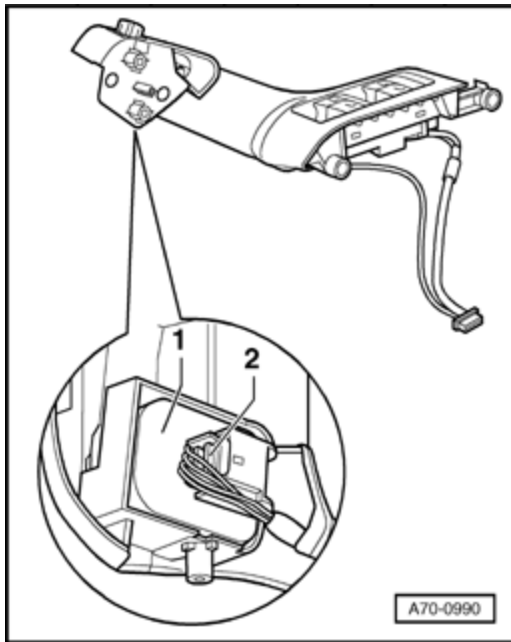

- Use a screwdriver to pry out mirror adjustment switch - **1** - .
- Remove connector - **2** - .

Installing

- Install mirror adjustment switch - **1** - in reverse order of removal.

.

Interior Door Release Mechanism with Central Locking Switch

Special tools, testers and auxiliary items required

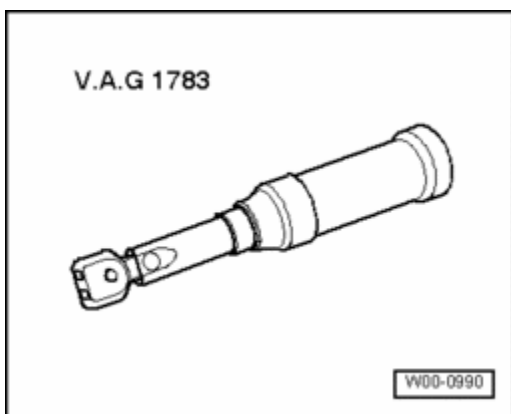

- ♦ Torque wrench V.A.G 1783/

Removing

- Remove door trim ⇒ [Front Door Trim](#) .

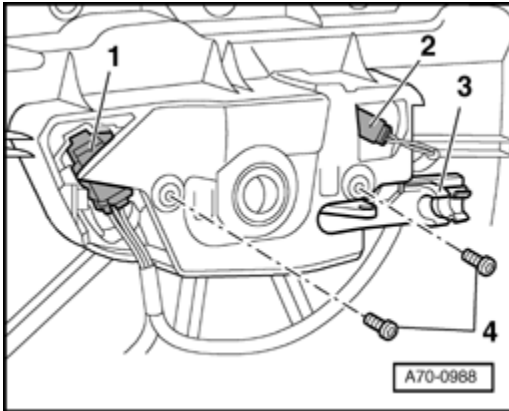

- Remove connector - **1** - .
- Remove connector - **2** - .
- Remove bolts - **4** - (Qty. 2).
- ♦ Tightening torque: 2 Nm.
- Remove inner door mechanism on front side of door trim.

Installing

- Make sure that cable of connector - **2** - lies behind bracket - **3** - .
- Install interior door mechanism in reverse order of removal.

▪

Door Warning Lamps and Footwell Lighting

Removing

- Remove door trim ⇒ [Front Door Trim](#) .

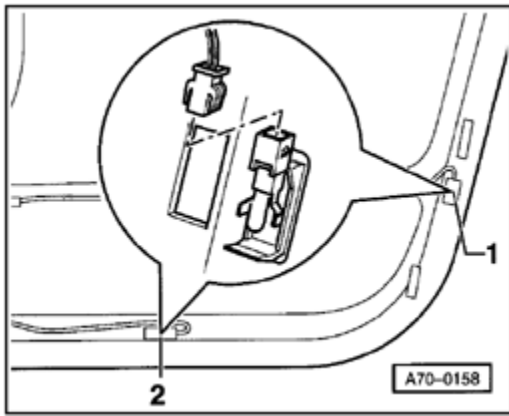

- Using a screwdriver, pry out door warning light - **1** - from below and pull out door warning light - **1** - with cable.
- Disconnect connector on door warning light - **1** - .
- Using a screwdriver, pry out exit light - **2** - from below and pull out exit light - **2** - with cable.
- Disconnect connector on exit light - **2** - .

Installing

Installation is reverse of removal.

.

Interior Monitoring Switch Strip

- ♦ With door trim removed:

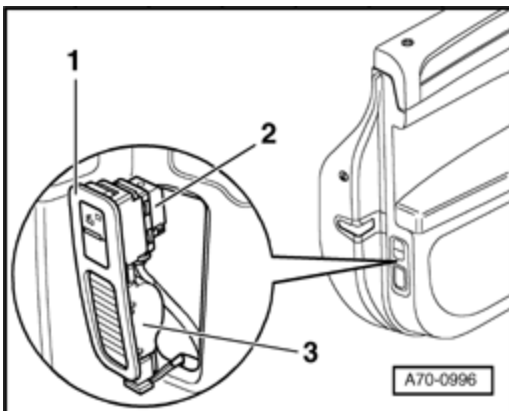

- Push out interior monitoring switch strip - **1** - from inside.
- Disconnect harness connectors - **2** - and - **3** - .

♦ With door trim installed:

- Carefully pry out interior monitoring switch strip - **1** - from above using a screwdriver.
- Disconnect harness connectors - **2** - and - **3** - .

▪

Hinged Pocket with Mount

Special tools, testers and auxiliary items required

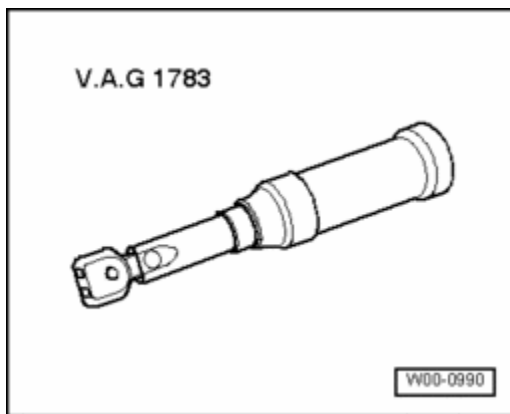

♦ Torque wrench V.A.G 1783/

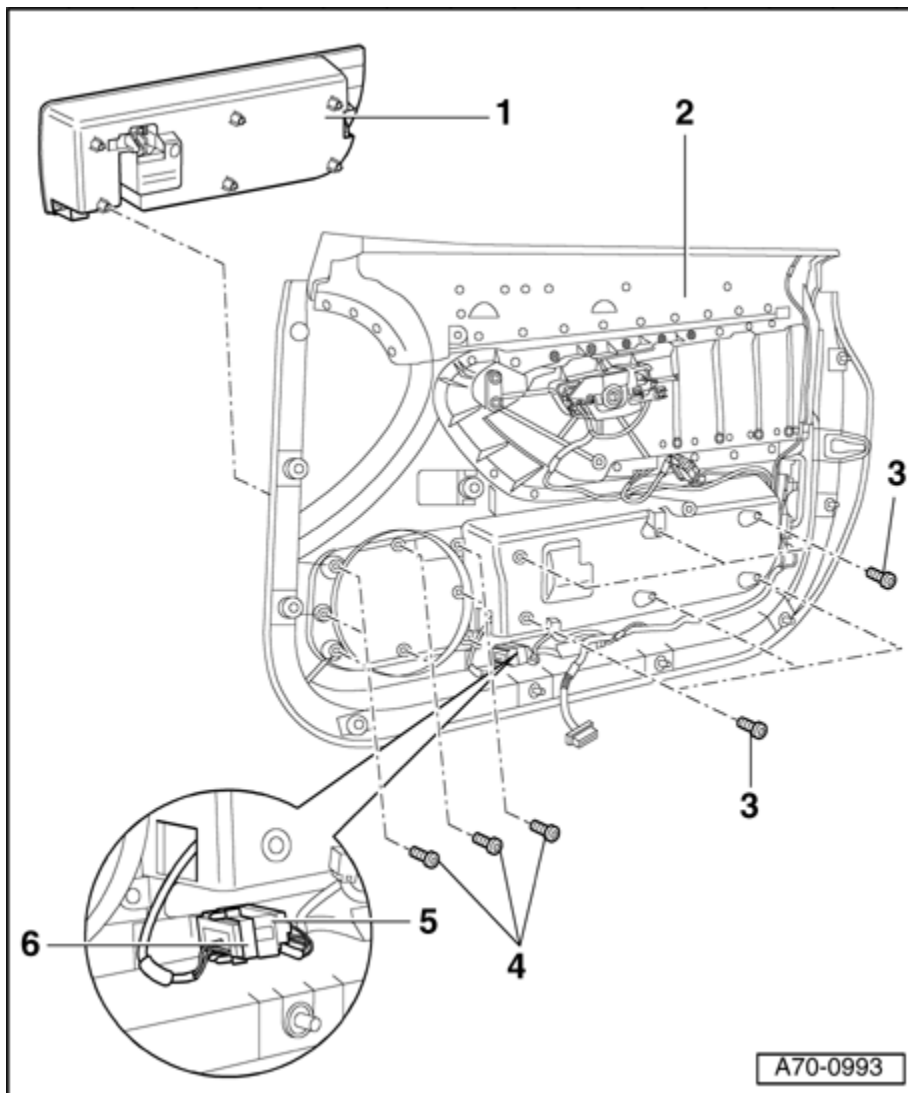

1 - Hinged pocket with mount

◆ Removing

- Remove door trim ⇒ [Front Door Trim](#) and ⇒ [Front Door Trim](#) .
- Remove insulation ⇒ [Insulation](#) and ⇒ [Front Door Trim](#) .
- Remove bolts - **4** - (Qty. 8).
- Remove bolts - **3** - (Qty. 6).
- Unclip connector guide - **6** - from door trim - **2** - .
- Disconnect connector - **5** - .
- Remove the connector guide - **6** - from the connector - **5** - .

- Remove hinged pocket with mount - **1** - on front side of door trim - **2** - .

- ♦ Installing

- Install hinged pocket with mount - **1** - in reverse order of removal.

2 - Door trim

3 - Screws (Qty. 6)

- ♦ Tightening torque: 2 Nm.

4 - Bolts (Qty. 8)

- ♦ Tightening torque: 2 Nm.

5 - Harness connector for tank lid/rear lid release switch strip

6 - Connector guide

.

Hinged Pocket

Removing

- Remove door trim ⇒ [Front Door Trim](#) .
- Remove insulation ⇒ [Insulation](#) and ⇒ [Front Door Trim](#) .
- Remove hinged pocket with mount ⇒ [Hinged Pocket with Mount](#) .

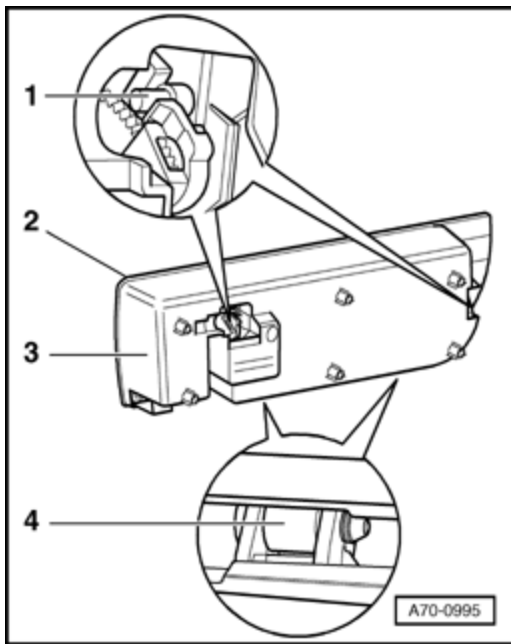

- Pull out pins - **1** - (Qty. 2) using pliers.
- Using a screwdriver, pry out bolts - **4** - (Qty. 2).
- Remove hinged pocket - **2** - from mount - **3** - .

Installing

- Install hinged pocket - **2** - in reverse order of removal.

▪

Tank Door/Rear Lid Release Switch

Removing

- Remove door trim ⇒ [Front Door Trim](#) .
- Remove insulation ⇒ [Insulation](#) and ⇒ [Front Door Trim](#) .
- Remove hinged pocket with mount ⇒ [Hinged Pocket with Mount](#) .

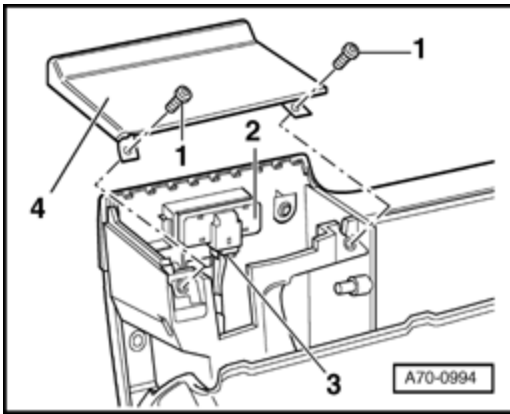

- Remove bolts - **1** - (Qty. 2).
- Remove cover - **4** - .
- Pry out switch - **2** - on right side and pull off switch - **2** - .
- Remove connector - **3** - .

Installing

- Install tank lid/rear lid release switch in reverse order of removal.

Copyright © 2008 Audi of America, Inc. and Bentley Publishers. All rights reserved. Last processed: