

Trims

Removing and installing B-pillar trim

- Cross-head screw - 0.5 Nm
 - ◆ 2 off
- Three-point seat belt
- Upper B-pillar trim
 - ◆ Removing:
 - – Remove lower B-pillar trim -Item [4](#)-.
 - – Remove front grab handle and coat hook => Page [70-31](#).
 - – Unclip upper A-pillar trim in rear area.
 - – Unscrew seat belt from seat => Fig. [69-16](#).
 - – Remove cross-head screws -Item [1](#)- and -Item [7](#)-.
 - – Ease three point seat belt -Item [2](#)- out of B-pillar trim.

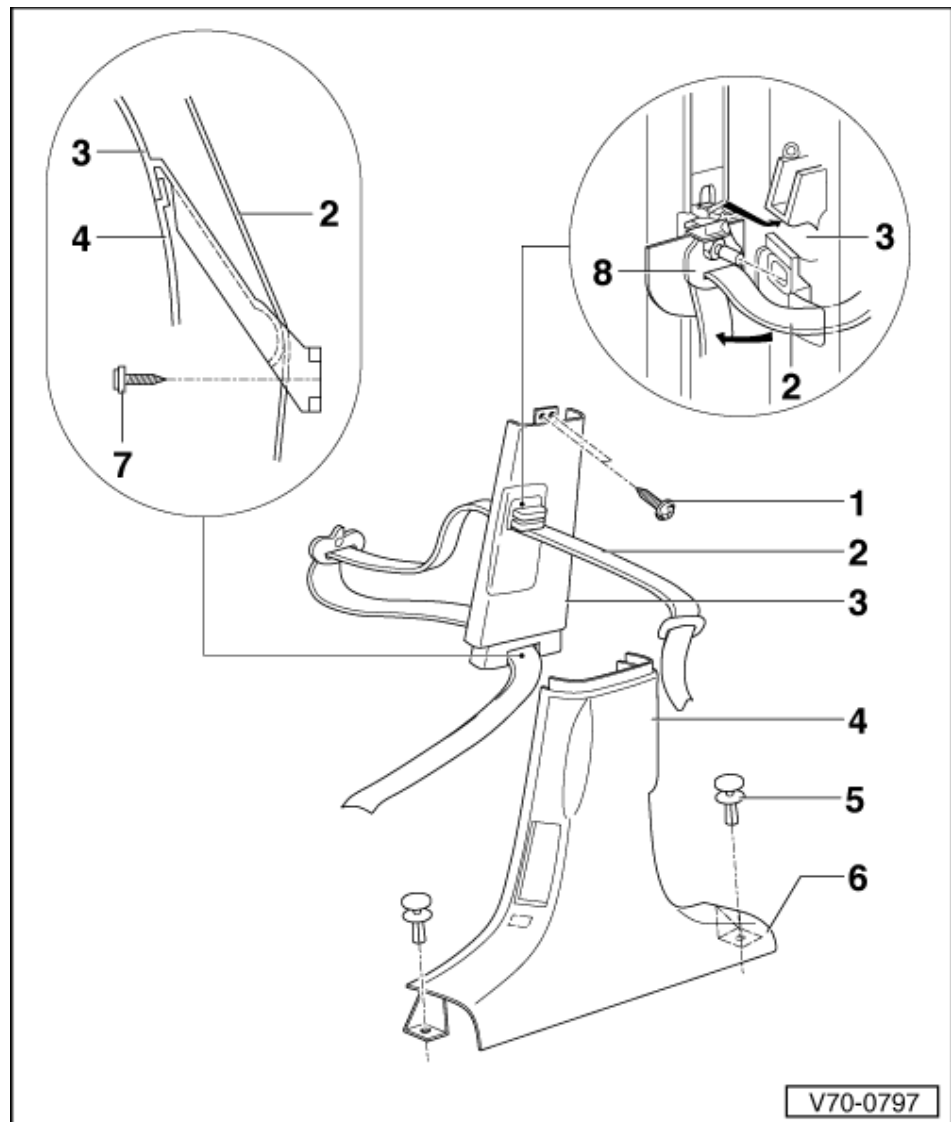

- – Ease three point seat belt -Item [2](#)- out of B-pillar trim.
- ◆ Installing:
- – Assemble B-pillar trim with height adjuster -Item [8](#)- as shown

Note:

Do not press button for manual height adjustment when installing.

- – Clip in B-pillar trim

twice at both
front and rear
of B-pillar.

Notes:

- ♦ Manual belt height adjustment mechanism must be heard to engage in all 5 positions
- ♦ After being actuated button must always return to upper position.

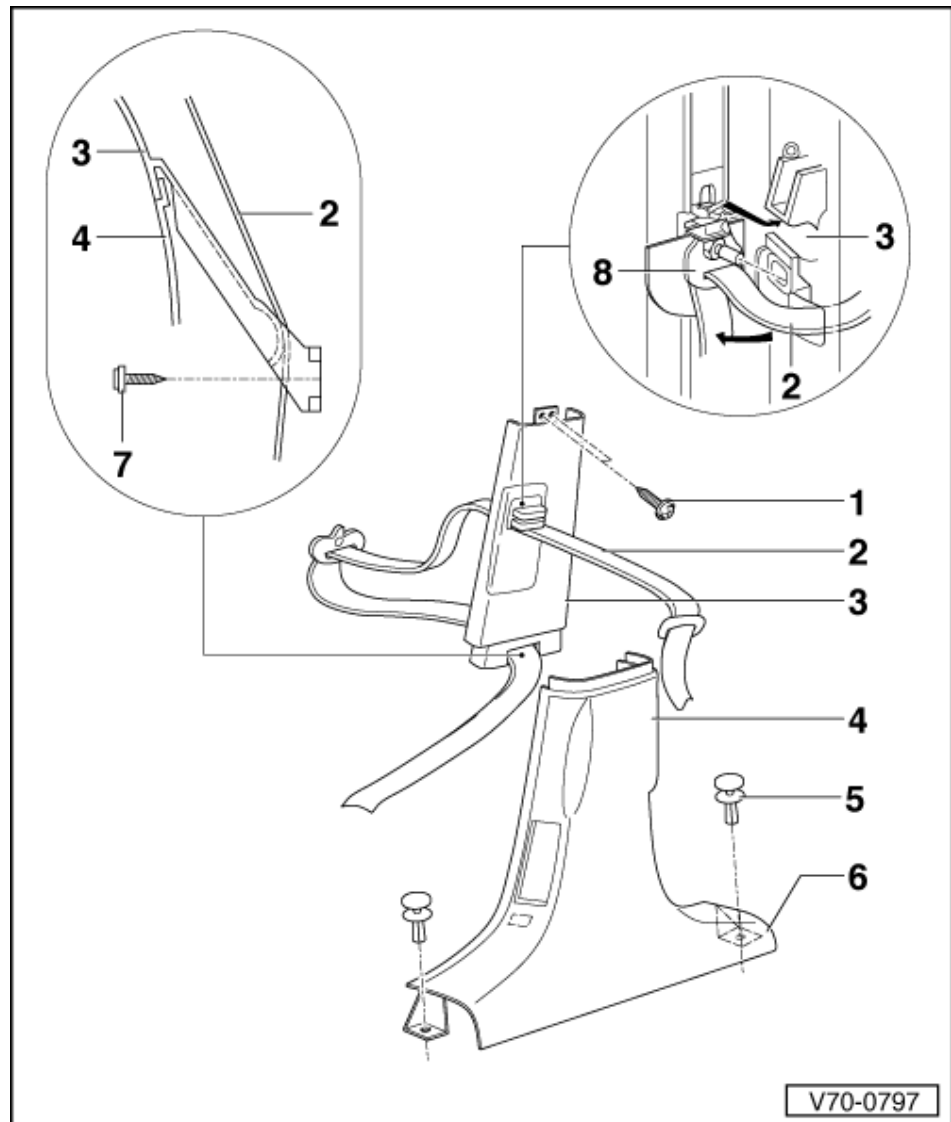

- Lower B-pillar trim
 - ♦ Removing:
 - – Unclip front sill panel trim => Page [70-46](#).
 - – Unclip lower C-pillar trim at transition to B-pillar trim.
 - – Remove clips -Item [5](#)-.
 - – Lift trim slightly and detach connectors.
 - – Detach trim downwards.
- Clip
 - ♦ 2 off
- B-pillar
- Cross-head screw -

- 0.5 Nm
 ○ ◆ 3 off
 • Height adjuster

